

## 5 TROUBLESHOOTER

| Symptom   | Possible Cause  | Remedy   |
|---|---|--|
| No water flow from inlet valve.                                 | Mains supply tap not open.<br>Isolating valve not open<br>Filter blocked<br>Float arm not free to move<br>Float stuck on/in float chamber   | Open supply tap.<br>Open isolating valve.<br>Remove filter and clean.<br>Mount valve correctly, straighten bent float stem.<br>Adjust float/float chamber height (ensure float remains inside float chamber at all times). |
| Inlet valve not shutting off.                                   | Seal missing on float lever arm<br>Filter and 'O' ring missing<br>Valve has become dislodged from mounting bracket<br>Float chamber/float set too high<br>Float lever arm dislodged from mounting<br>Front nut loose<br><br>Monitoring pin seized | Replace seal in arm.<br>Replace filter and 'O' ring.<br>Re-engage valve in bracket.<br>Adjust float chamber/float position.<br>Re-fit or replace lever arm.<br>Tighten nut.<br><br>Replace diaphragm assembly.             |
| Low flow from inlet valve.                                      | Filter blocked  | Clean filter.  |
| Turbulent and noisy flow from inlet valve.                      | scale build up on overhead discharge nozzle<br>Damaged overhead discharge nozzle  | Replace overhead discharge nozzle.<br>Replace overhead discharge nozzle.   |
| Internally overflowing.   | Inlet valve not shutting off<br>Water level set too high  | See 'B' above.<br>Lower float on inlet valve.  |
| Outlet valve not closing. (Water continually running into pan). | Bellows not evacuating all air<br>Build up of debris on seal face of housing or seal  | Relieve by removing pipe to valve.<br>Clean surfaces.  |
| Outlet valve closing before full volume delivered.              | Seal not clearing window<br>Lack of air to inflate bellows<br>Push button leaking<br>Bellows poorly fitted to lever mount   | Check for leaks on bellows and push button.<br>Check push button for leaks.<br>Replace push button.<br>Push-fit bellows into lever mount.  |
| Outlet valve not operating with push button.                    | Pneumatic pipes not connected<br>Bellows poorly fitted to lever mount<br>Bellows leaking<br>Push button leaking   | Re-connect pipes.<br>Push-fit bellows into lever mount.<br>Replace bellows.<br>Replace push button.  |
| Leaking from flush pipe connection.                             | Damaged 'O' rings on cistern outlet<br>Flush pipe seam protruding<br>Flush pipe cut at angle<br>Flush pipe cracked  | Replace 'O' rings.<br>Trim seam with knife.<br>Replace flush pipe and cut square.<br>Replace flush pipe.   |
| Partial flush volume when operating full flush button.          | Wrong position of pneumatic pipes   | Substitute pipes.  |
| Full flush volume when operating partial flush button.          | Adjustable weight not retained on locating studs<br><br>Wrong position of pneumatic pipes   | Re-connect weight.<br><br>Substitute pipes.  |
| Button sticking on Vantage with Niagara valve.                  | Collet not located correctly  | Ensure collet is fully engaged.  |

# Dudley Vantage™

## Concealed Cistern Installation Instructions

Please leave this instruction leaflet with the end user

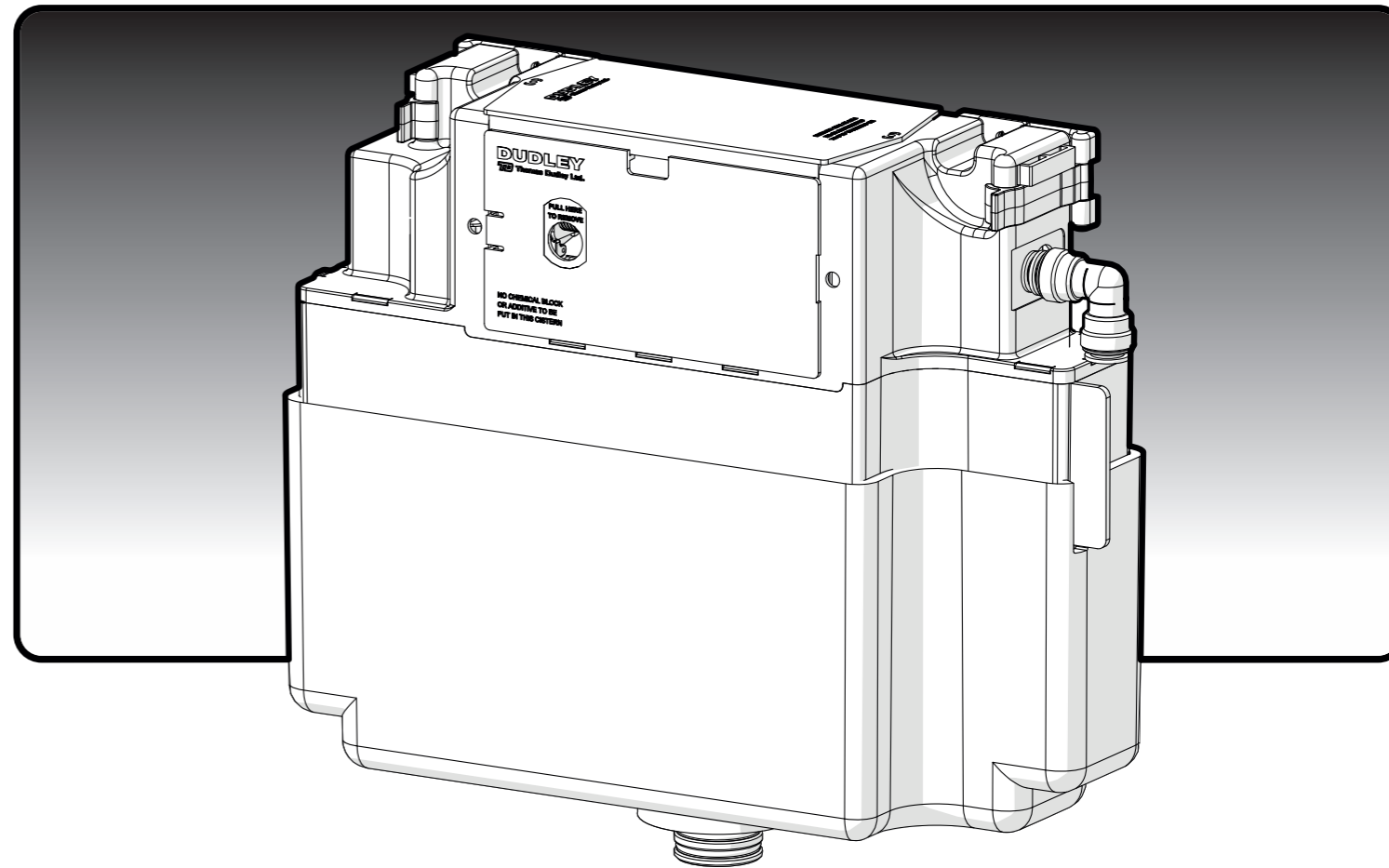

### 1 PACK CONTENTS

**IMPORTANT: Check contents, make sure all the parts are accounted for before discarding packaging. If any parts are missing, do not attempt to install the cistern until you obtain all the missing parts.**

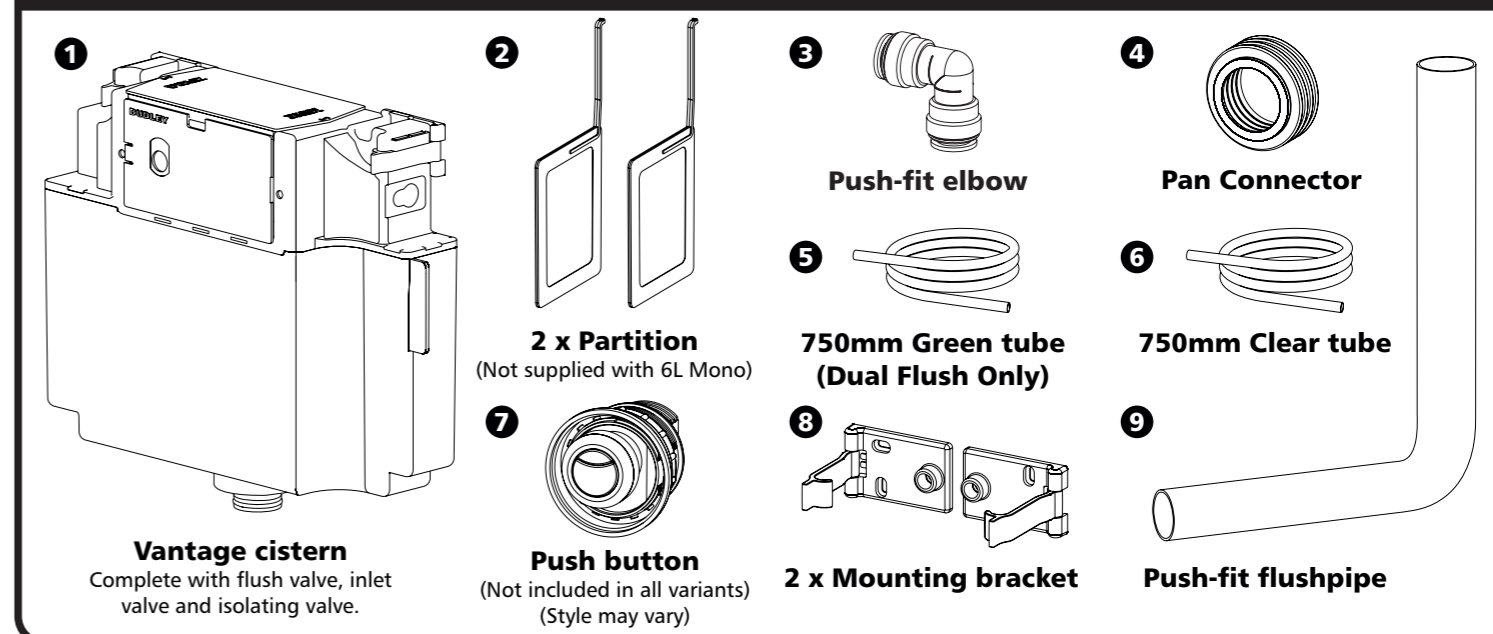

**Dudley**  
Water saving solutions

0121 530 7000

0121 557 5345

sales@thomasdudley.co.uk

www.dudleybathroomproducts.co.uk

Thomas Dudley Ltd, P.O.Box 28, Birmingham New Road, Dudley, West Midlands, DY1 4SN

## 2 VANTAGE CISTERN INSTALLATION

### Fit Vantage cistern to wall

**Note:** Prior to installation ensure there is sufficient space for the Vantage to be installed

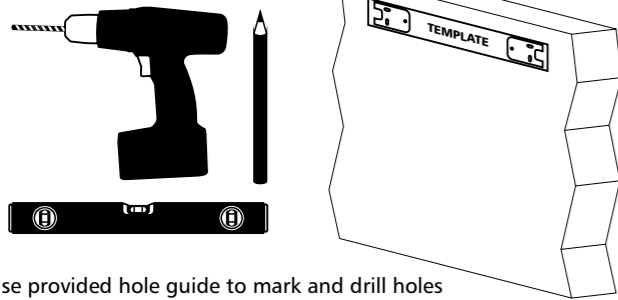

- 1 Use provided hole guide to mark and drill holes to suit No.8 CSK screws ensuring template is level (Guide located on front flap of box)

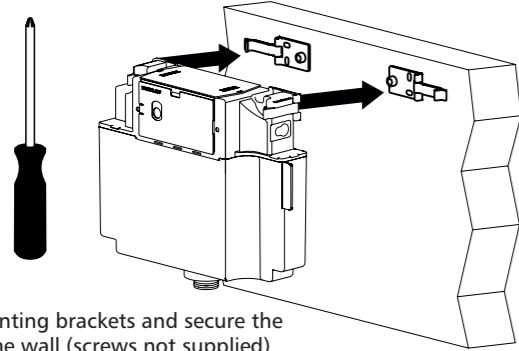

- 2 Fit the mounting brackets and secure the cistern to the wall (screws not supplied)

### Connect inlet and check water level

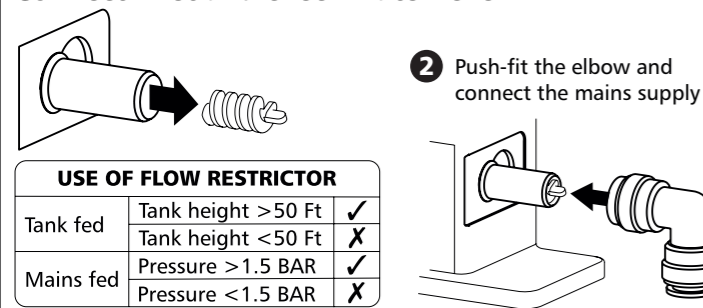

- 2 Push-fit the elbow and connect the mains supply

| USE OF FLOW RESTRICTOR |                     |   |
|------------------------|---------------------|---|
| Tank fed               | Tank height > 50 Ft | ✓ |
|                        | Tank height < 50 Ft | ✗ |
| Mains fed              | Pressure > 1.5 BAR  | ✓ |
|                        | Pressure < 1.5 BAR  | ✗ |

- 1 Remove factory fitted flow restrictor if necessary (See table above)

### Fit flush pipe

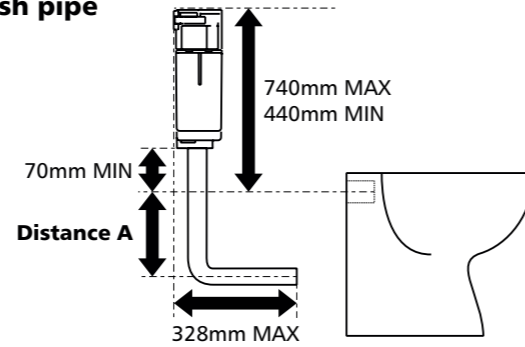

- 1 Fit flush pipe to Vantage cistern and measure **Distance A**

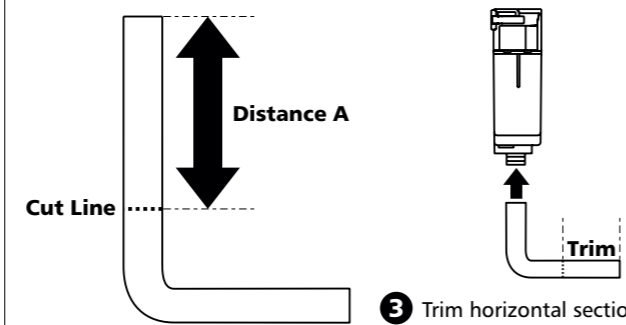

- 2 Cut **Distance A** from larger diameter section of flush pipe
- 3 Trim horizontal section of flush pipe to suit WC pan installation. Re-fit flush pipe to Vantage cistern and connect to WC pan

### Converting the Vantage cistern flush capacity (if required)

- 1 Fit or remove partitions as required

**Dual Flush**  
 6/4 Litre - No Partitions ✓  
 5/3 Litre - One Partition ✗  
 4/2.6 Litre - Two Partitions ✗

**Mono Flush**  
 6 Litre - No Partitions ✓  
 5 Litre - One Partition ✗  
 4 Litre - Two Partitions ✗

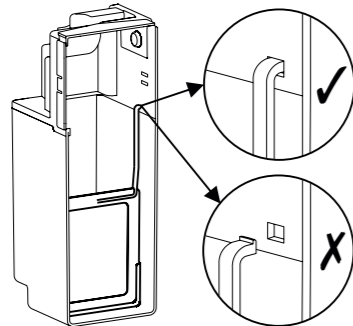

- 2 Configure Niagara valve

**Remove Niagara Valve**  
 Twist Niagara valve anti-clockwise to release from Vantage cistern  
 Reverse operation to re-fit

**Adjust weight**  
 Twist adjustable weight anti-clockwise to unlock  
 Slide to required level and relock into position

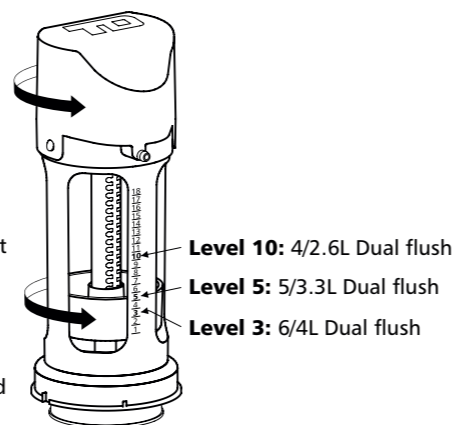

**WARNING:** No sealing compound, paste, flux or solvent to be used in contact with plastic or rubber surfaces to avoid damage. Rubber washers or 'O' rings should provide an adequate seal. PTFE tape may be used on threads. Do not over tighten plastic nuts.  
**No chemical block or additive is to be used in this installation.**

### FINAL INSTALLATION CHECK LIST:

- Check all moving components operate freely and the inlet valve shuts off correctly.
- If overflowing or poor flushing subsequently occurs, check that the float and arm move freely up and down and that the water level is correct.
- Check all joints are tightened correctly.
- Check carefully for leaks.
- Hold the inlet valve float down, causing the cistern to internally overflow. Ensure the overflow pipe is capable of discharging all incoming water without the cistern overflowing. If overflowing persists contact:

Technical Help @ Thomas Dudley Ltd on 0121 530 7000

## 3 VANTAGE CISTERN MAINTENANCE

### Removal of internal components

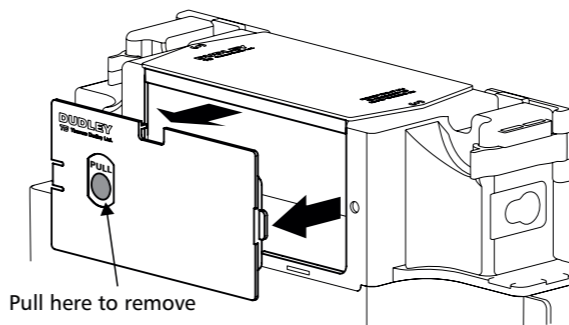

- 1 Remove front service cover

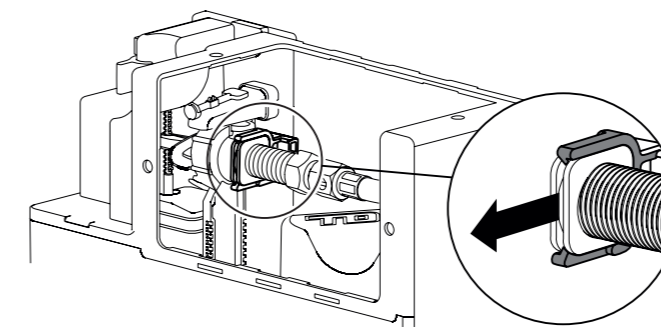

- 3 Remove the Hydroflo valve from mounting clip

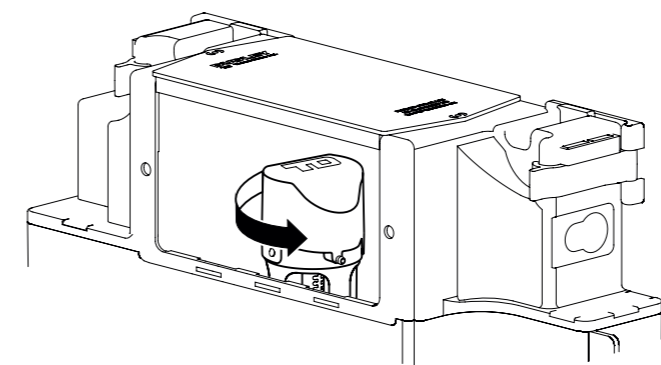

- 5 Twist the Niagara valve anti-clockwise to release

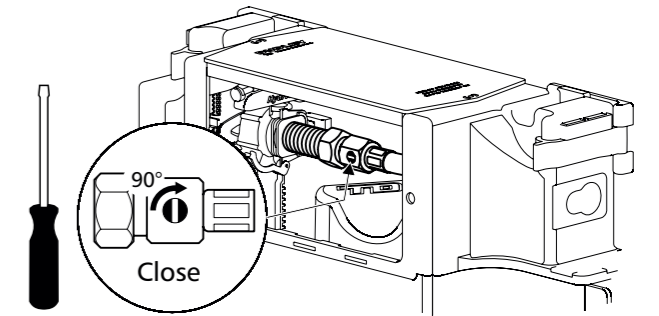

- 2 Close isolation valve and flush to empty cistern

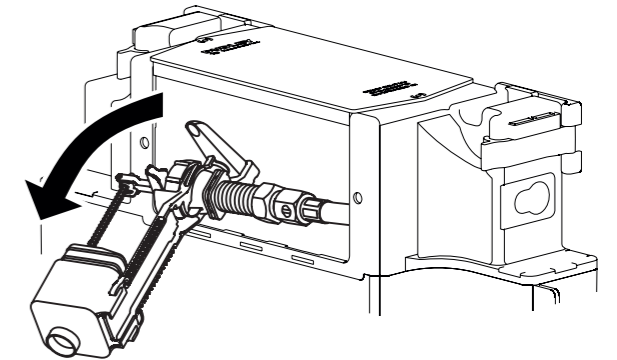

- 4 Remove the Hydroflo valve through the service aperture

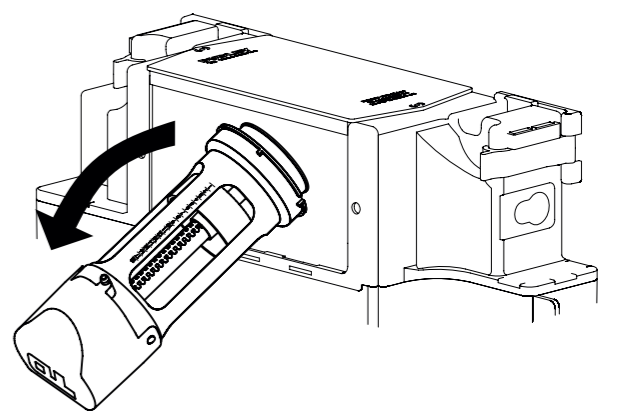

- 6 Remove the Niagara valve through the service aperture

### Hydroflo inlet valve maintenance

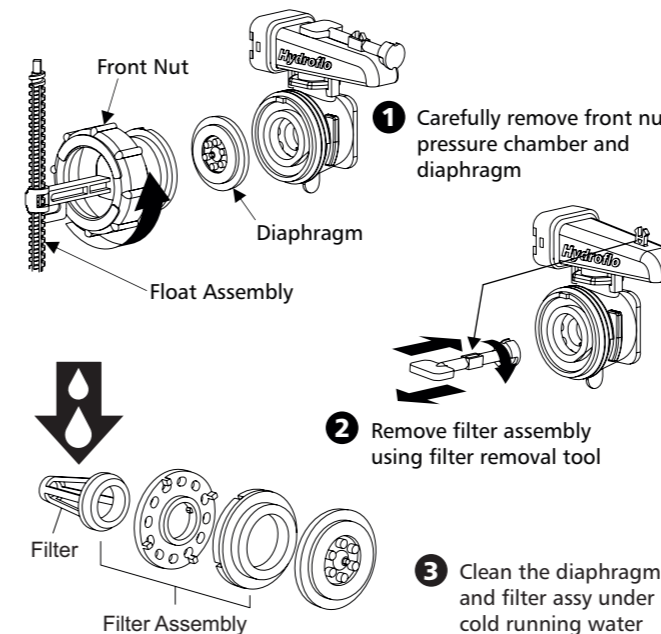

### Niagara outlet valve maintenance

